

**AUBURN JUNCTION INFORMATION**

**PHASE I**

FLOOR 1: RETAIL - 27,000 SQ. FT.  
 FLOOR 1: GARAGE - 34,000 SQ. FT.  
 (PARKING STALLS - 102)  
 FLOOR 2: RETAIL - 46,000 SQ. FT.  
 FLOOR 3: RETAIL - 46,000 SQ. FT.  
 FLOOR 4: HOTEL - 30,000 SQ. FT. (40 ROOMS)  
 FLOOR 5: HOTEL - 30,000 SQ. FT. (60 ROOMS)  
 FLOOR 6: HOTEL - 29,000 SQ. FT. (60 ROOMS)  
 TOTAL FLOOR AREA: 242,000 SQ. FT.

**PHASE II**

FLOOR 1: RETAIL - 22,000 SQ. FT.  
 FLOOR 1: RESIDENTIAL - 8,000 SQ. FT.  
 FLOOR 1: GARAGE - 25,000 SQ. FT.  
 (PARKING STALLS - 98)  
 FLOOR 2: RESIDENTIAL - 33,000 SQ. FT. (30 UNITS)  
 FLOOR 3: RESIDENTIAL - 33,000 SQ. FT. (30 UNITS)  
 FLOOR 4: RESIDENTIAL - 33,000 SQ. FT. (30 UNITS)  
 FLOOR 5: RESIDENTIAL - 32,000 SQ. FT. (24 UNITS)  
 FLOOR 6: RESIDENTIAL - 32,000 SQ. FT. (24 UNITS)  
 TOTAL FLOOR AREA: 218,000 SQ. FT.

**PHASE III**

FLOOR 1: RETAIL - 43,000 SQ. FT.  
 FLOOR 1: GARAGE - 22,000 SQ. FT.  
 (PARKING STALLS - 96)  
 FLOOR 2: RESIDENTIAL - 32,000 SQ. FT. (30 UNITS)  
 FLOOR 3: RESIDENTIAL - 32,000 SQ. FT. (30 UNITS)  
 FLOOR 4: RESIDENTIAL - 32,000 SQ. FT. (30 UNITS)  
 FLOOR 5: RESIDENTIAL - 32,000 SQ. FT. (30 UNITS)  
 FLOOR 6: RESIDENTIAL - 29,000 SQ. FT. (20 UNITS)  
 TOTAL FLOOR AREA: 222,000 SQ. FT.

**PHASE IV**

FLOOR 1: RETAIL - 27,000 SQ. FT.  
 FLOOR 1: GARAGE - 24,000 SQ. FT.  
 (PARKING STALLS - 97)  
 FLOOR 2: OFFICE - 33,000 SQ. FT.  
 FLOOR 3: OFFICE - 33,000 SQ. FT.  
 FLOOR 4: OFFICE - 33,000 SQ. FT.  
 FLOOR 5: OFFICE - 32,000 SQ. FT.  
 FLOOR 6: OFFICE - 32,000 SQ. FT.  
 TOTAL FLOOR AREA: 214,000 SQ. FT.

**ON - SITE STRUCTURED PARKING**  
 STRUCTURE PARKING: 393 STALLS  
 TOTAL PARKING: 1,930 STALLS

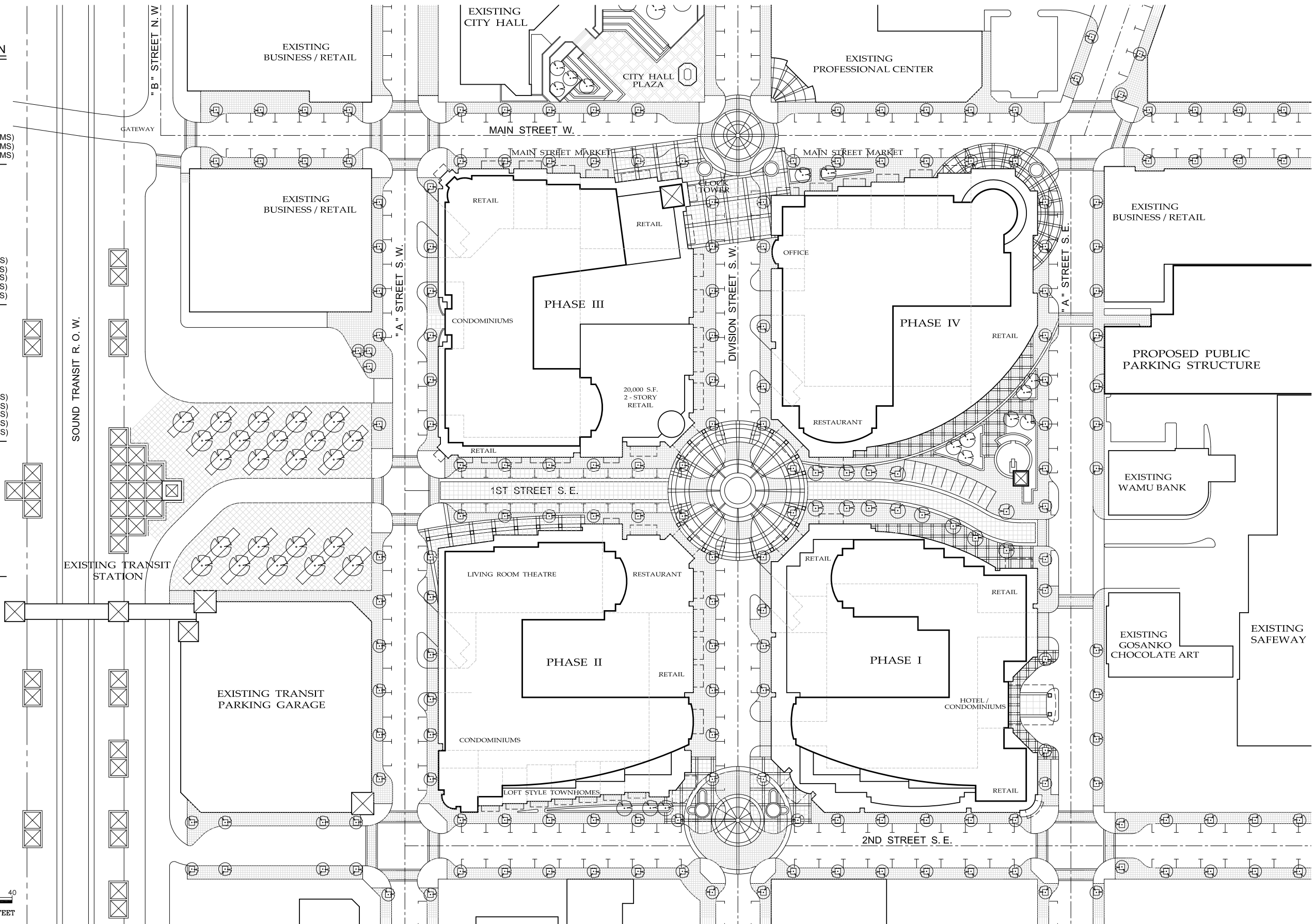

**AUBURN JUNCTION**  
 AUBURN, WASHINGTON



**SCHEMATIC SITE PLAN**  
 SCALE: 1"=40'  
 APRIL 20, 2009